

DigiBore Product Overview



DigiBore VERSATILE FINE BORING

Advanced versatile technology.

The Wohlhaupter® DigiBore boring head provides internal balancing, which makes this tool the stress-free choice to meet your required surface finish. Its digital display allows for quick and accurate diameter corrections at the machine.

Engineered with the *future in mind*.

- Diameter range: 0.118" - 8.189" (3.00 mm - 208.00 mm)
- Offers outside turning capabilities: 0.157" - 4.488" (4.00 mm - 114.00 mm)
- Digital readout for simple 0.0001" (0.002 mm) diameter adjustments
- Ease the stress of working on different day-to-day projects with boring kits
- Automatic internal balancing improves surface finish, tool life, and accuracy
- Max spindle speed: 16,000 RPM
- Max coolant pressure: 580 PSI (40 bar)



NOTE: Imperial items pictured

NOTE: Adjustment accuracy of 0.0001" or 0.002 mm on diameter

IMPORTANT: Max spindle speed refers to maximum possible speed for an individual boring head and is not a recommended parameter. Refer to page B10-M: 12 for recommended application-specific parameters. Factory technical assistance is available for your specific applications through our Application Engineering department.
ext: 7611 | email: appeng@alliedmachine.com



DigiBore Head

NOTE: Imperial items pictured
NOTE: Adjustment accuracy of 0.0001" or 0.002 mm on diameter

DIGI BORE

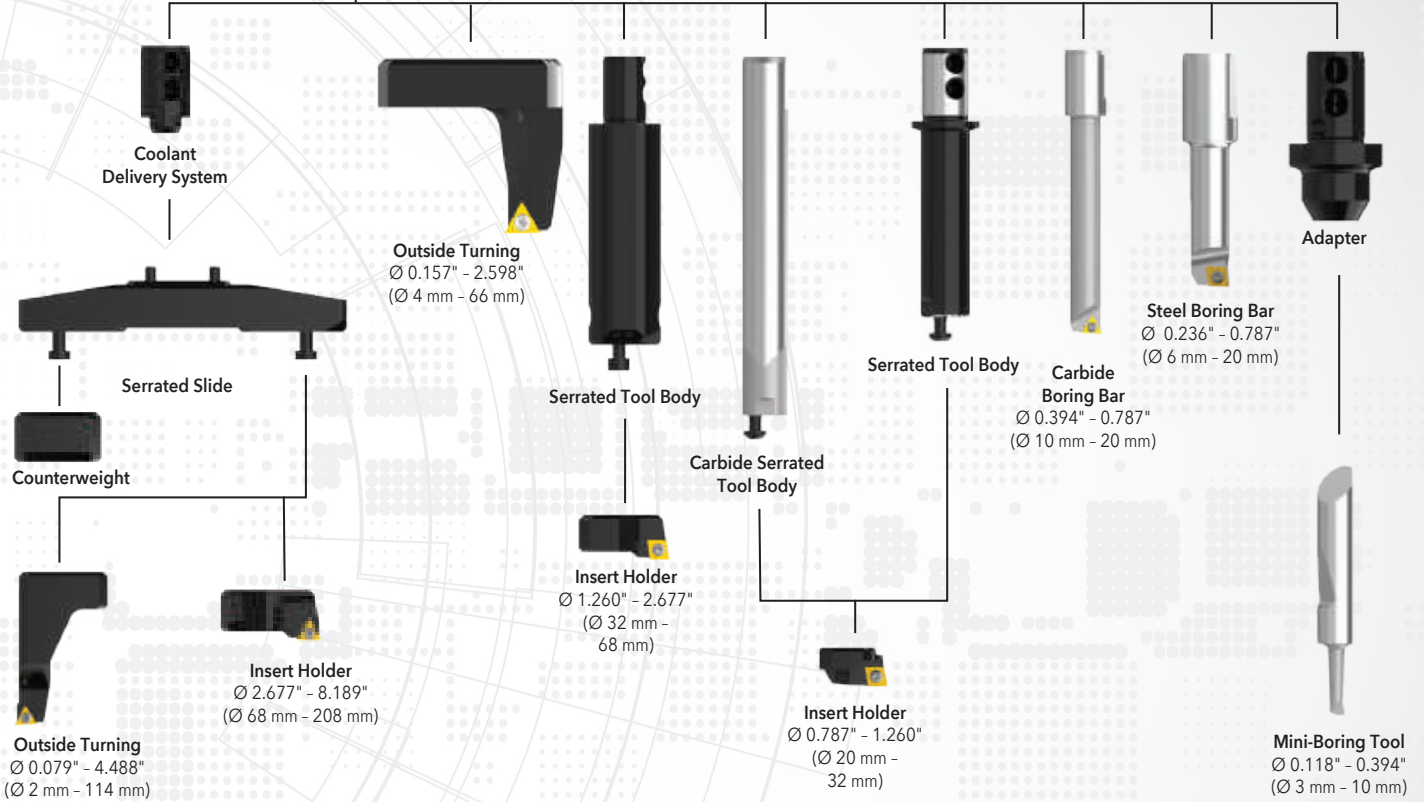

OPERATION **VERSATILITY**

from **0.118"** to **8.189"** (3.00 mm to 208.00 mm)
plus outside turning



NOTE: Imperial items pictured
NOTE: Adjustment accuracy of 0.0001"
or 0.002 mm on diameter

Boring Heads

Diameter Range: 0.118" - 8.189" (3.00 mm - 208.00 mm)

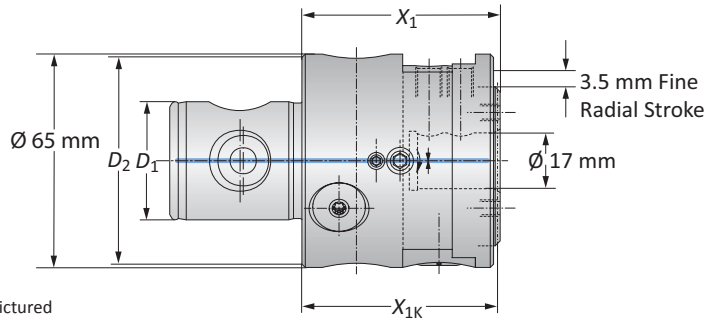

NOTE: Imperial items pictured
NOTE: Adjustment accuracy of 0.0001" or 0.002 mm on diameter

DigiBore Boring Heads

	MVS Connection		Boring Head		Weight	Part No.
	D_2 D_1	Boring Range	X_1	X_{1K}		
i	50 - 28	0.118 - 8.189	2.362	2.342	2.866 (lbs)	504003
	63 - 36	0.118 - 8.189	2.362	2.342	3.307 (lbs)	504001
m	50 - 28	3.00 - 208.00	60.00	59.50	1.30 (kg)	501005
	63 - 36	3.00 - 208.00	60.00	59.50	1.50 (kg)	501001

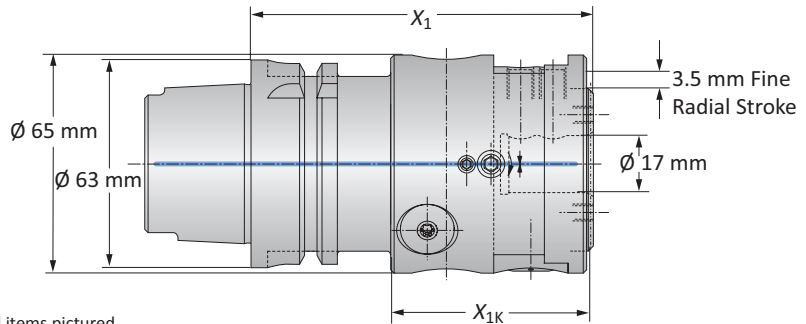

NOTE: Imperial items pictured
NOTE: Adjustment accuracy of 0.0001" or 0.002 mm on diameter

DigiBore Boring Heads

	Connection		Boring Head		Weight	Part No.
	Connection	Boring Range	X_1	X_{1K}		
i	HSK-A 63	0.118 - 8.189	4.015	2.342	4.630 (lbs)	504004
	PSC 63 (Polygon Shank)	0.118 - 8.189	4.015	2.342	4.630 (lbs)	504019
m	HSK-A 63	3.00 - 208.00	102.00	59.50	2.10 (kg)	501004
	PSC 63 (Polygon Shank)	3.00 - 208.00	102.00	59.50	2.10 (kg)	501019

Key on B10-A: 1

B10-M: 12-15

B10-F

B10: vi-vii

i = Imperial (in)
m = Metric (mm)

IMPORTANT: Max spindle speed refers to maximum possible speed for an individual boring head and is not a recommended parameter. Refer to page B10-M: 12 for recommended application-specific parameters. Factory technical assistance is available for your specific applications through our Application Engineering department.
ext: 7611 | email: appeng@alliedmachine.com

Mini Boring Bars

WHC05 | WHW04 | WBN150 | Diameter Range: 0.118" - 0.394" (3.00 mm - 10.00 mm)

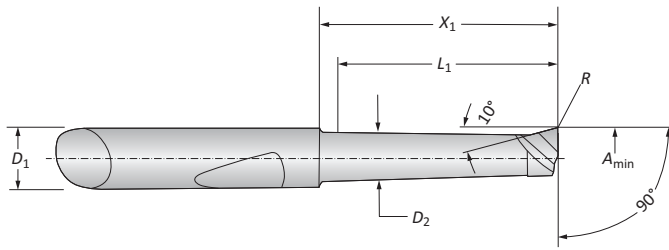

Mini Boring Bars

	Boring Range		Boring Bar				Part No.		
	A_{min}	D_1	D_2	X_1	L_1	R	Coated Carbide	Uncoated Carbide	CBN
i	0.118	0.236	0.102	0.452	0.393	0.003	081306WHC05	-	081322WBN150
	0.118	0.236	0.102	0.649	0.590	0.003	081307WHC05	081307WHW04	-
	0.157	0.236	0.141	0.472	0.393	0.007	081308WHC05	-	081317WBN150
	0.157	0.236	0.141	0.669	0.590	0.007	081309WHC05	-	081341WBN150
	0.157	0.236	0.141	0.866	0.787	0.007	081310WHC05	081310WHW04	-
	0.196	0.236	0.181	0.472	0.393	0.007	081311WHC05	-	081318WBN150
	0.196	0.236	0.181	0.866	0.787	0.007	081312WHC05	-	081319WBN150
	0.196	0.236	0.181	1.259	1.181	0.007	081313WHC05	081313WHW04	-
	0.236	0.236	0.220	0.866	0.787	0.007	081314WHC05	-	081320WBN150
	0.236	0.236	0.220	1.259	1.181	0.007	081315WHC05	-	081321WBN150
	0.236	0.236	0.220	1.653	1.574	0.007	081316WHC05	081316WHW04	-
	0.315	0.315	0.229	0.984	0.905	0.007	081323WHC05	-	-
0.315	0.315	0.229	1.968	1.889	0.007	081324WHC05	-	-	
m	3.00	6.00	2.60	11.50	10.00	0.10	081306WHC05	-	081322WBN150
	3.00	6.00	2.60	16.50	15.00	0.10	081307WHC05	081307WHW04	-
	4.00	6.00	3.60	12.00	10.00	0.20	081308WHC05	-	081317WBN150
	4.00	6.00	3.60	17.00	15.00	0.20	081309WHC05	-	081341WBN150
	4.00	6.00	3.60	22.00	20.00	0.20	081310WHC05	081310WHW04	-
	5.00	6.00	4.60	12.00	10.00	0.20	081311WHC05	-	081318WBN150
	5.00	6.00	4.60	22.00	20.00	0.20	081312WHC05	-	081319WBN150
	5.00	6.00	4.60	32.00	30.00	0.20	081313WHC05	081313WHW04	-
	6.00	6.00	5.60	22.00	20.00	0.20	081314WHC05	-	081320WBN150
	6.00	6.00	5.60	32.00	30.00	0.20	081315WHC05	-	081321WBN150
	6.00	6.00	5.60	42.00	40.00	0.20	081316WHC05	081316WHW04	-
	8.00	8.00	7.60	25.00	23.00	0.20	081323WHC05	-	-
8.00	8.00	7.60	50.00	48.00	0.20	081324WHC05	-	-	



Adapters

	Boring Range		Adapter				Weight	Part No.
	A_{min}	X_1	L_1	D_3	D_5			
m	3.00 - 8.00	22.50	14.00	6.00	20.00	0.04 (kg)	501050	
	8.00 - 10.00	22.50	14.00	8.00	22.00	0.04 (kg)	501051	

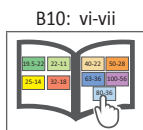
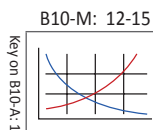
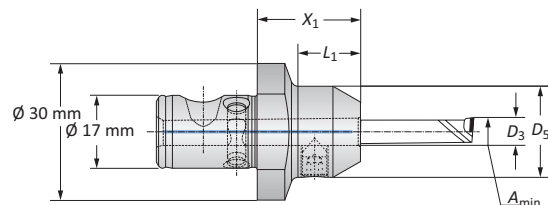

i = Imperial (in)
m = Metric (mm)

A
B
C
D
E
F
G
H
I
J
K
L
M
INDEX

Boring Bars

Steel | Diameter Range: 0.236" - 0.787" (6.00 mm - 20.00 mm)



Form 101

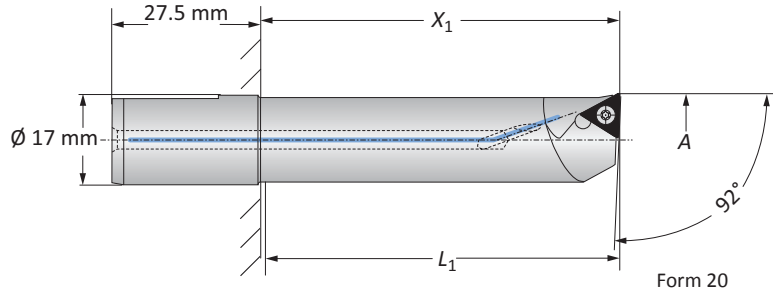

Boring Range	Boring Bar		Weight	Insert Form	Part No.	Insert Form	Part No.
	A	X ₁					
0.236 - 0.315	0.866	0.748	0.110 (lbs)	211*	502068	-	-
0.315 - 0.394	1.181	1.063	0.110 (lbs)	211*	502066	-	-
0.394 - 0.433	1.181	1.063	0.132 (lbs)	101	502012	20*	502001
0.433 - 0.472	1.181	1.063	0.132 (lbs)	101	502075	20*	502070
0.472 - 0.512	1.772	1.654	0.154 (lbs)	101	502013	20*	502002
0.512 - 0.551	1.772	1.654	0.176 (lbs)	101	502076	20*	502071
0.551 - 0.591	1.968	1.850	0.176 (lbs)	101	502014	20*	502003
0.591 - 0.630	1.968	1.850	0.198 (lbs)	101	502077	20*	502072
0.630 - 0.669	2.362	2.244	0.220 (lbs)	101	502015	20*	502004
0.669 - 0.709	2.362	2.244	0.265 (lbs)	101	502078	20*	502073
0.709 - 0.748	2.677	2.559	0.287 (lbs)	101	502016	20*	502005
0.748 - 0.787	2.677	2.559	0.309 (lbs)	101	502079	20*	502074
<hr/>							
6.00 - 8.00	22.00	19.00	0.05 (kg)	211*	502068	-	-
8.00 - 10.00	30.00	27.00	0.05 (kg)	211*	502066	-	-
10.00 - 11.00	30.00	27.00	0.06 (kg)	101	502012	20*	502001
11.00 - 12.00	30.00	27.00	0.06 (kg)	101	502075	20*	502070
12.00 - 13.00	45.00	42.00	0.07 (kg)	101	502013	20*	502002
13.00 - 14.00	45.00	42.00	0.08 (kg)	101	502076	20*	502071
14.00 - 15.00	50.00	47.00	0.08 (kg)	101	502014	20*	502003
15.00 - 16.00	50.00	47.00	0.09 (kg)	101	502077	20*	502072
16.00 - 17.00	60.00	57.00	0.10 (kg)	101	502015	20*	502004
17.00 - 18.00	60.00	57.00	0.12 (kg)	101	502078	20*	502073
18.00 - 19.00	68.00	65.00	0.13 (kg)	101	502016	20*	502005
19.00 - 20.00	68.00	65.00	0.14 (kg)	101	502079	20*	502074

*Not suitable for indexable inserts with a radius of 0.031" (0.80 mm)

Key on B10-A: 1

B10-M: 12-15

B10-H

B10: vi-vii

i = Imperial (in)
m = Metric (mm)
Inserts sold separately

A
B
C
D
E
F
G
H
I
J
K
L
M
INDEX

Boring Bars

Carbide | Diameter Range: 0.394" - 0.787" (10.00 mm - 20.00 mm)



Form 101

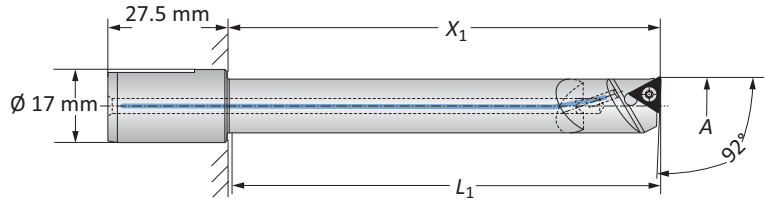

Form 20

	Boring Range		Boring Bar		Weight	Insert Form	Part No.	Insert Form	Part No.
	A	X ₁	L ₁						
i	0.394 - 0.472	2.165	2.047	0.265 (lbs)	101	502093	20*	502088	
	0.394 - 0.472	2.756	2.638	0.309 (lbs)	101	502034	20*	502023	
	0.472 - 0.551	2.559	2.441	0.287 (lbs)	101	502094	20*	502089	
	0.472 - 0.551	3.346	3.228	0.375 (lbs)	101	502035	20*	502024	
	0.551 - 0.630	2.953	2.835	0.375 (lbs)	101	502095	20*	502090	
	0.551 - 0.630	3.543	3.425	0.485 (lbs)	101	502036	20*	502025	
	0.630 - 0.709	3.346	3.228	0.573 (lbs)	101	502096	20*	502091	
	0.630 - 0.709	4.331	4.213	0.706 (lbs)	101	502037	20*	502026	
	0.709 - 0.787	3.740	3.622	0.617 (lbs)	101	502097	20*	502092	
0.709 - 0.787	4.724	4.606	0.882 (lbs)	101	502038	20*	502027		
m	10.00 - 12.00	55.00	52.00	0.12 (kg)	101	502093	20*	502088	
	10.00 - 12.00	70.00	67.00	0.14 (kg)	101	502034	20*	502023	
	12.00 - 14.00	65.00	62.00	0.13 (kg)	101	502094	20*	502089	
	12.00 - 14.00	85.00	82.00	0.18 (kg)	101	502035	20*	502024	
	14.00 - 16.00	75.00	72.00	0.17 (kg)	101	502095	20*	502090	
	14.00 - 16.00	90.00	87.00	0.22 (kg)	101	502036	20*	502025	
	16.00 - 18.00	85.00	82.00	0.26 (kg)	101	502096	20*	502091	
	16.00 - 18.00	110.00	107.00	0.32 (kg)	101	502037	20*	502026	
	18.00 - 20.00	95.00	92.00	0.28 (kg)	101	502097	20*	502092	
18.00 - 20.00	120.00	117.00	0.40 (kg)	101	502038	20*	502027		

*Not suitable for indexable inserts with a radius of 0.031" (0.80 mm)

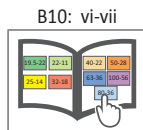
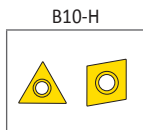
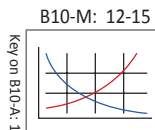

i = Imperial (in)
m = Metric (mm)
 Inserts sold separately

A
B
C
D
E
F
G
H
I
J
K
L
M
INDEX

Serrated Tool Bodies | Insert Holders

Steel | Carbide | Diameter Range: 0.787" - 1.260" (20.00 mm - 32.00 mm)

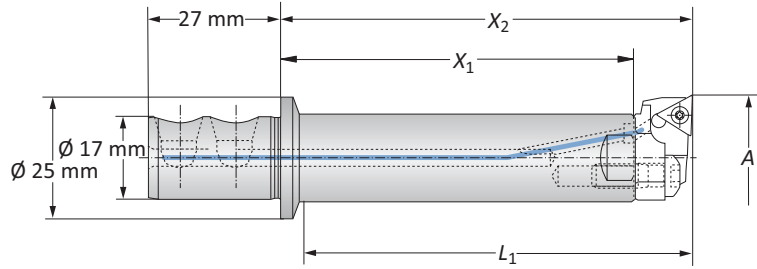

Steel Serrated Tool Bodies

	Boring Range	Serrated Tool Body			Weight	Part No.
	A	X ₁	X ₂	L ₁		
i	0.787 - 1.260	2.835	3.307	3.031	0.441 (lbs)	502045
m	20.00 - 32.00	72.00	84.00	77.00	0.20 (kg)	502045

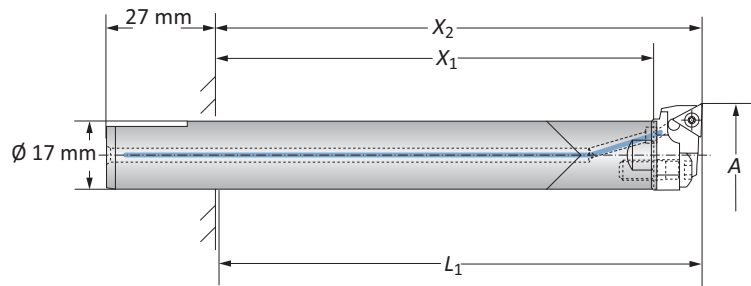

Carbide Serrated Tool Bodies

	Boring Range	Serrated Tool Body			Weight	Part No.
	A	X ₁	X ₂	L ₁		
i	0.787 - 1.260	4.252	4.724	4.606	0.882 (lbs)	502062
m	20.00 - 32.00	108.00	120.00	117.00	0.40 (kg)	502062

Insert Holders

	Boring Range	Insert Holder	Weight	Insert Form	Part No.	Insert Form	Part No.
	A	X ₁					
i	0.787 - 0.866	0.472	0.022 (lbs)	101	502052	20*	502046
	0.866 - 0.945	0.472	0.022 (lbs)	101	502053	20*	502047
	0.945 - 1.024	0.472	0.022 (lbs)	101	502054	20*	502048
	1.024 - 1.102	0.472	0.022 (lbs)	101	502055	20*	502049
	1.102 - 1.181	0.472	0.022 (lbs)	101	502056	20*	502050
	1.181 - 1.260	0.472	0.022 (lbs)	101	502057	20*	502051
m	20.00 - 22.00	12.00	0.01 (kg)	101	502052	20*	502046
	22.00 - 24.00	12.00	0.01 (kg)	101	502053	20*	502047
	24.00 - 26.00	12.00	0.01 (kg)	101	502054	20*	502048
	26.00 - 28.00	12.00	0.01 (kg)	101	502055	20*	502049
	28.00 - 30.00	12.00	0.01 (kg)	101	502056	20*	502050
	30.00 - 32.00	12.00	0.01 (kg)	101	502057	20*	502051

*Not suitable for indexable inserts with a radius of 0.031" (0.80 mm)

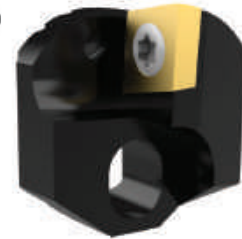

Form 101

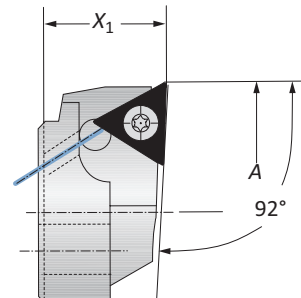

Form 20

Key on B10-A: 1

B10-M: 12-15

B10-A: 71

B10-H

B10: vi-vii

i = Imperial (in)
m = Metric (mm)
 Inserts sold separately

Alu-Line Serrated Tool Bodies | Insert Holders

Diameter Range: 1.260" - 2.677" (32.00 mm - 68.00 mm)

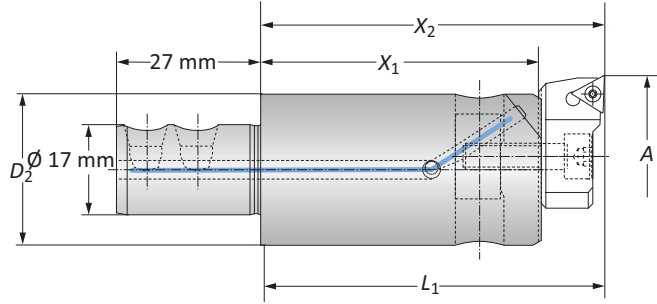

Alu-Line Serrated Tool Bodies

	Boring Range	Serrated Tool Body				Weight	Part No.
	A	D ₂	X ₁	X ₂	L ₁		
i	1.260 - 1.968	1.122	2.047	2.598	2.480	0.220 (lbs)	501052
	1.260 - 1.968	1.122	3.465	4.016	3.898	0.441 (lbs)	501060
	1.968 - 2.677	1.811	2.402	2.953	2.835	0.441 (lbs)	501053
	1.968 - 2.677	1.811	4.173	4.724	4.606	0.661 (lbs)	501061
m	32.00 - 50.00	28.50	52.00	66.00	63.00	0.10 (kg)	501052
	32.00 - 50.00	28.50	88.00	102.00	99.00	0.20 (kg)	501060
	50.00 - 68.00	46.00	61.00	75.00	72.00	0.20 (kg)	501053
	50.00 - 68.00	46.00	106.00	120.00	117.00	0.30 (kg)	501061



Form 101

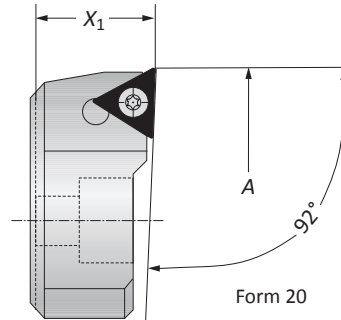

Form 20

Insert Holders

	Serrated Tool Body	Boring Range	Insert Holder	Weight	Insert Form	Part No.
		A	X ₁			
i	501052 / 501060	1.260 - 1.614	0.551	0.066 (lbs)	20*	502060
		1.614 - 1.968	0.551	0.088 (lbs)	20*	502061
		1.260 - 1.614	0.551	0.066 (lbs)	101	502058
		1.614 - 1.968	0.551	0.088 (lbs)	101	502059
	501053 / 501061	1.968 - 2.323	0.551	0.066 (lbs)	20*	502060
		2.323 - 2.677	0.551	0.088 (lbs)	20*	502061
		1.968 - 2.323	0.551	0.066 (lbs)	101	502058
		2.323 - 2.677	0.551	0.088 (lbs)	101	502059
m	501052 / 501060	32.00 - 41.00	14.00	0.03 (kg)	20*	502060
		41.00 - 50.00	14.00	0.04 (kg)	20*	502061
		32.00 - 41.00	14.00	0.03 (kg)	101	502058
		41.00 - 50.00	14.00	0.04 (kg)	101	502059
	501053 / 501061	50.00 - 59.00	14.00	0.03 (kg)	20*	502060
		59.00 - 68.00	14.00	0.04 (kg)	20*	502061
		50.00 - 59.00	14.00	0.03 (kg)	101	502058
		59.00 - 68.00	14.00	0.04 (kg)	101	502059

*Not suitable for indexable inserts with a radius of 0.031" (0.80 mm)

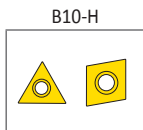
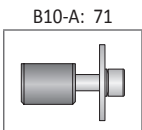
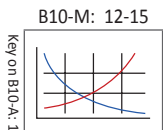

i = Imperial (in)
m = Metric (mm)
Inserts sold separately

A
B
C
D
E
F
G
H
I
J
K
L
M
INDEX

Alu-Line Serrated Slides | Insert Holders

Diameter Range: 2.667" - 8.189" (68.00 mm - 208.00 mm)

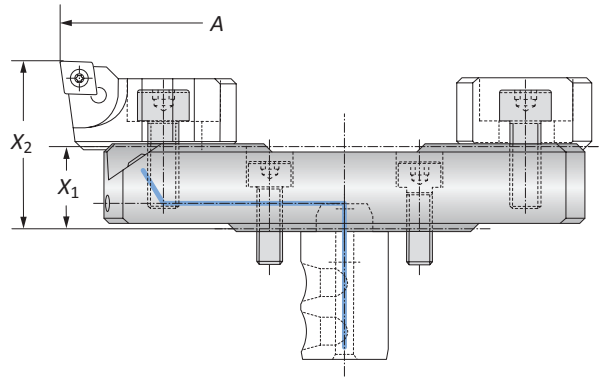

Alu-Line Serrated Slides

	Boring Range	Serrated Slide		Weight	Part No.
	A	X ₁	X ₂		
i	2.667 - 3.780	0.630	1.280	0.220 (lbs)	501054
	3.780 - 4.881	0.630	1.280	0.220 (lbs)	501055
	4.881 - 5.984	0.630	1.280	0.441 (lbs)	501056
	5.984 - 7.088	0.866	1.516	0.551 (lbs)	501058
	7.088 - 8.189	0.866	1.516	0.661 (lbs)	501059
m	68.00 - 96.00	16.00	32.50	0.10 (kg)	501054
	96.00 - 124.00	16.00	32.50	0.10 (kg)	501055
	124.00 - 152.00	16.00	32.50	0.20 (kg)	501056
	152.00 - 180.00	22.00	38.50	0.25 (kg)	501058
	180.00 - 208.00	22.00	38.50	0.30 (kg)	501059

Insert Holders

	Boring Range	Weight	Insert Form	Part No.
	A			
i	2.677 - 8.189	0.110 (lbs)	101	502064
	2.677 - 8.189	0.110 (lbs)	20	502069
m	68.00 - 208.00	0.05 (kg)	101	502064
	68.00 - 208.00	0.05 (kg)	20	502069

NOTE: Other insert holders available upon request



Form 20

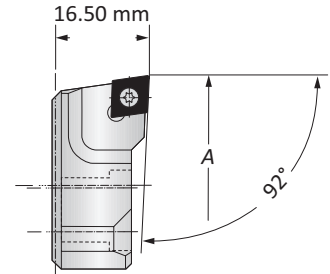

Form 101

Counterweights

	Counterweight	Weight	Part No.
	X ₁		
i	0.528	0.110 (lbs)	502165
m	13.40	0.05 (kg)	502165

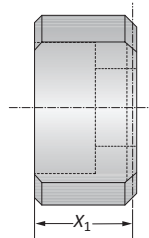

Coolant Delivery Systems

	Coolant Delivery System	Part No.
	Weight	
i	0.044 (lbs)	501157
m	0.02 (kg)	501157

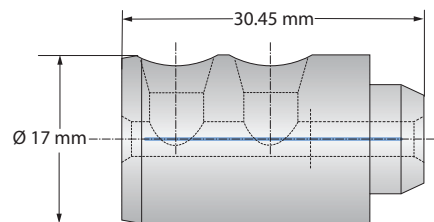

B10-M: 12-15

B10-A: 71

B10-H

B10: vi-vii

Key on B10-A: 1

i = Imperial (in)
m = Metric (mm)

Inserts sold separately

Outside Turning Insert Holders for Boring Heads

Diameter Range: 0.157" - 2.598" (4.00 mm - 66.00 mm)

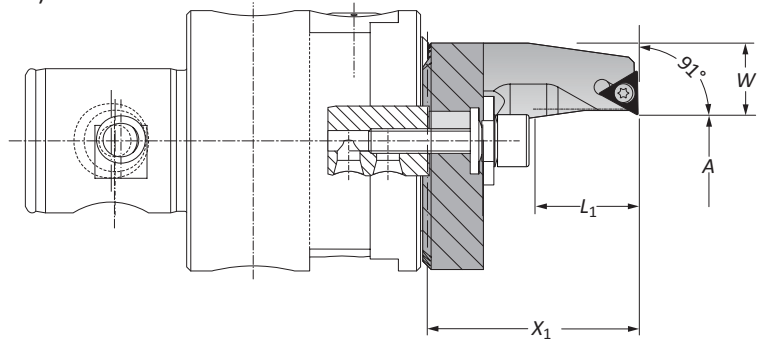

Type A Insert Holders | Diameter Range: 0.157" - 1.181" (4.00 mm - 30.00 mm)

	Boring Range		Insert Holder			Weight	Insert Form	Part No.
	A	X ₁	L ₁	W				
i	0.157 - 0.689	1.594	0.787	0.653	0.220 (lbs)	20*	236081	
	0.650 - 1.181	1.988	1.181	0.437	0.220 (lbs)	20*	236082	
m	4.00 - 17.50	40.50	20.00	16.60	0.10 (kg)	20*	236081	
	16.50 - 30.00	50.50	30.00	11.10	0.10 (kg)	20*	236082	

NOTE: Clockwise and neutral execution

*Not suitable for indexable inserts with a radius of 0.031" (0.80 mm)

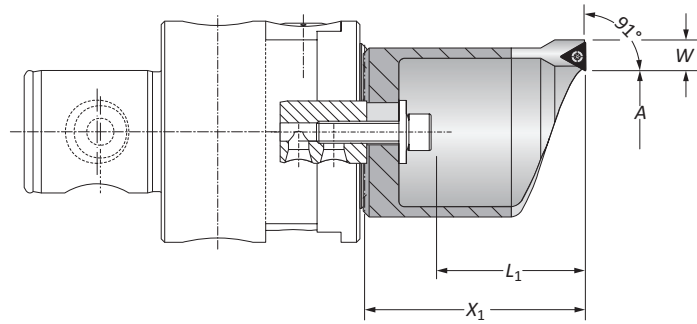

Type B Insert Holders | Diameter Range: 1.142" - 2.598" (29.00mm - 66.00mm)

	Boring Range		Insert Holder			Weight	Insert Form	Part No.
	A	X ₁	L ₁	W				
i	1.142 - 1.732	2.952	2.126	0.377	0.661 (lbs)	20*	236083	
	1.693 - 2.598	3.956	3.110	0.377	0.882 (lbs)	20*	236084	
m	29.00 - 44.00	75.50	54.00	9.60	0.30 (kg)	20*	236083	
	43.00 - 66.00	100.50	79.00	9.60	0.40 (kg)	20*	236084	

NOTE: Clockwise and neutral execution

*Not suitable for indexable inserts with a radius of 0.031" (0.80 mm)

Clamping Pieces for Outside Turning Insert Holders

	Insert Holder Type	Boring Range	Service Key	Complete Part No.
m	A	4.00 - 30.00	s5	502080
	B	29.00 - 66.00	s5	502081

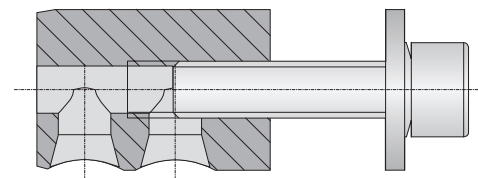

B10-M: 12-15

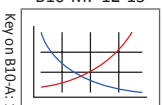

B10-A: 71

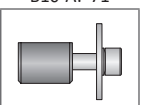

B10-H

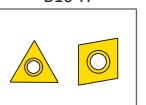

B10: vi-vii

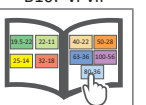

i = Imperial (in)
 m = Metric (mm)
 Inserts sold separately

A
B
C
D
E
F
G
H
I
J
K
L
M
INDEX

Outside Turning Serrated Slides | Insert Holders

Diameter Range: 0.078" - 4.488" (2.00 mm - 114.00 mm)

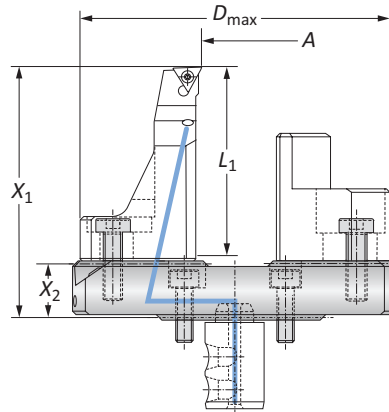

Outside Turning Serrated Slides

	Boring Range		Serrated Slide				Weight	Part No.
	A	X ₁	X ₂	L ₁	D _{max}			
i	0.078 - 1.181	2.874	0.630	2.165	3.396	0.771 (lbs)	501064	
	1.181 - 2.283	2.874	0.630	2.165	5.078	0.970 (lbs)	501065	
	2.283 - 3.385	3.110	0.866	2.165	6.181	1.322 (lbs)	501066	
	3.385 - 4.488	3.110	0.866	2.165	7.283	1.609 (lbs)	501067	
m	2.00 - 30.00	73.00	16.00	55.00	101.00	0.35 (kg)	501064	
	30.00 - 58.00	73.00	16.00	55.00	129.00	0.44 (kg)	501065	
	58.00 - 86.00	79.00	22.00	55.00	157.00	0.60 (kg)	501066	
	86.00 - 114.00	79.00	22.00	55.00	185.00	0.73 (kg)	501067	



Outside Turning Insert Holders

	Outside Turning Range	Insert Holder	Weight	Insert Form	Part No.
	A	X ₁			
i	0.079 - 4.488	2.244	0.331 (lbs)	20	502082
m	2.00 - 114.00	57.00	0.15 (kg)	20	502082

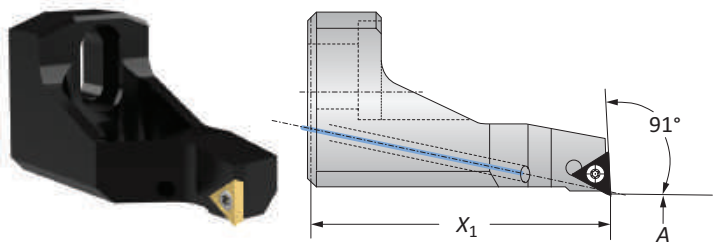

NOTE: Clockwise and neutral execution

Counterweights

	Counterweight		Part No.
	X ₁	Weight	
i	1.486	0.352 (lbs)	502183
m	37.75	0.16 (kg)	502183

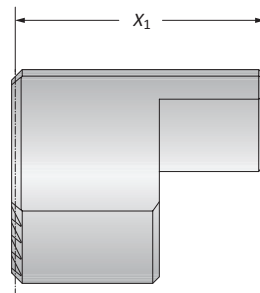

Coolant Delivery Systems

	Weight	Part No.
i	0.044 (lbs)	501157
m	0.02 (kg)	501157

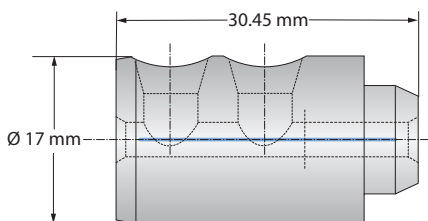

Key on B10-A: 1

B10-M: 12-15

B10-A: 71

B10-H

B10: vi-vii

i = Imperial (in)
m = Metric (mm)
Inserts sold separately

Accessories

No.	Part	Size	Part No.
1	Set screw	s3	415244
2	Screw for securing insert holder	T25	415112
3	Clamping piece	-	145184
4	Cap screw for securing insert holders	s4	027154
5	Cap screw for securing insert holder/ counterweight	s4	315248
6	Set screw - coolant	501054, 501055, 501056	s1.5 114224
		501058, 501059	s1.5 115303
7	Cap screw for securing serrated slide	s4	115166
8	Sealing ring for coolant delivery	-	415386

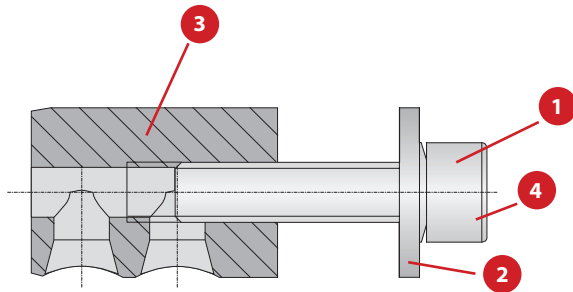
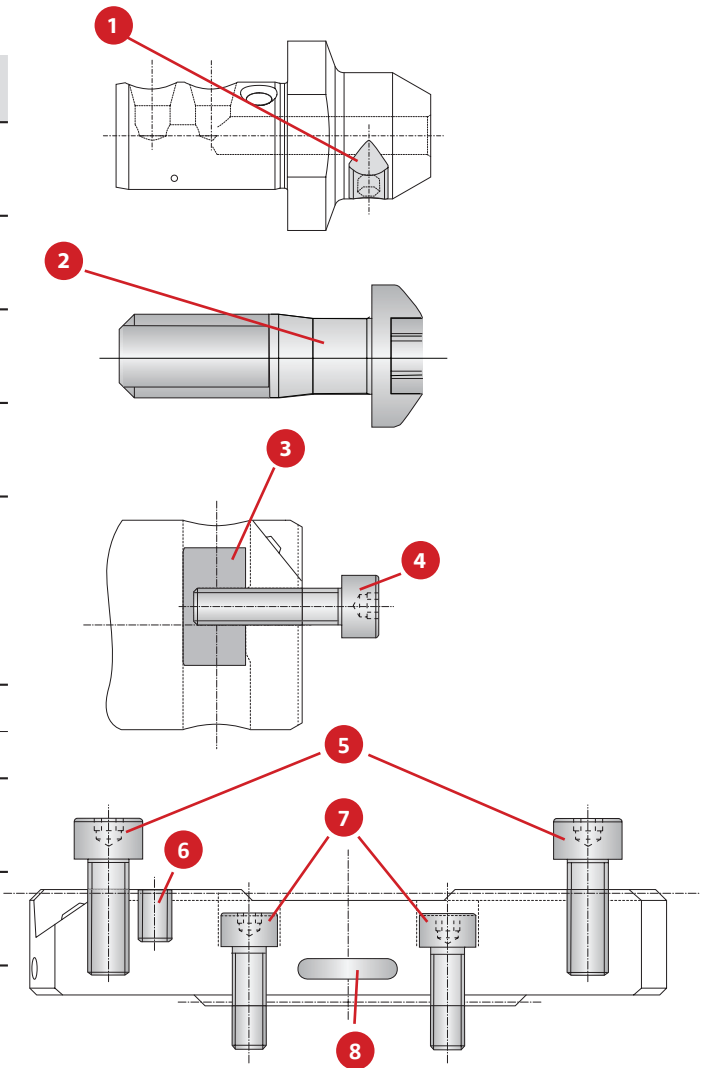

	Boring Range	Type	Hex Size	Clamping Screw Parts				Complete Part No.
				1 Cap Screw	2 Washer	3 Clamping Piece	4 Locking Washer	
i	0.157 - 1.181	A	s5	070153	315155	502180	215254	502080
	1.142 - 2.598	B	s5	070153	315156	502180	215254	502081
m	4.00 - 30.00	A	s5	070153	315155	502180	215254	502080
	29.00 - 66.00	B	s5	070153	315156	502180	215254	502081

A
B
C
D
E
F
G
H
I
J
K
L
M
INDEX

Accessories

No.	Part	Insert Form	Size	Part No.
1	Clamping screw	-	-	415353
2	Set screw for clamping tool	-	-	215674
3	Battery cover	-	-	415895
4	Battery*	-	-	415896
5	Battery access cover with sealing ring	-	-	501016
6	Insert screws	Form 211 Form 20 Form 101	T6 T7 T8	215377 115535 115676
7	Hex driver	-	s1.5 s3	215472 115630
8	Hex driver	-	s4	115576
9	Torx® driver	-	T6 T7 T8 T20	115537 115591 115590 215150
10	Torque screwdriver, Torx	(0.6 Nm) Form 211 (0.9 Nm) Form 20 (1.2 Nm) Form 101	T6 T7 T8	415507 415508 415514

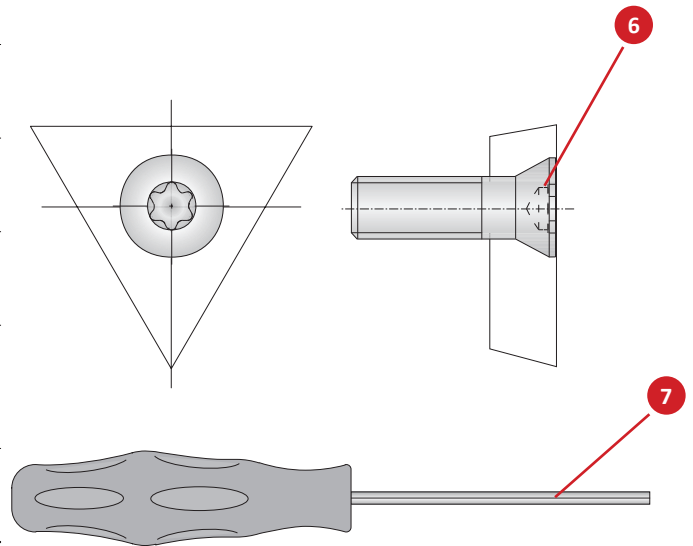
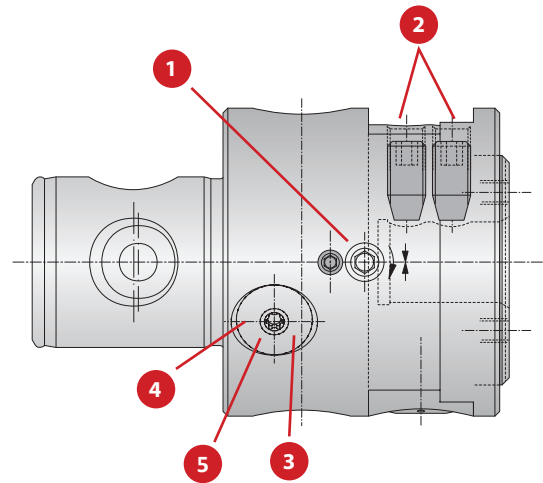

*Always change two batteries
NOTE: Please use VARTA batteries (V392 SR41)

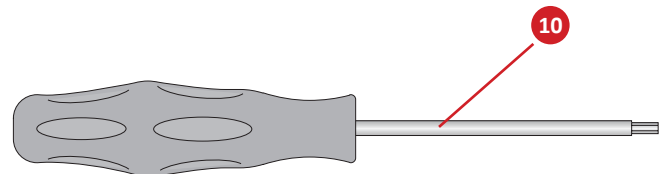
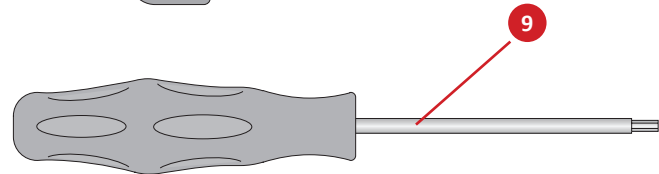
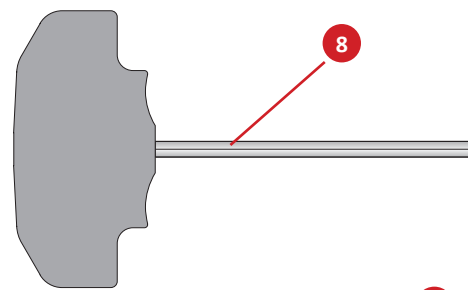

Kit Components

Insert Form 101 | Diameter Range: 0.394" - 1.260" (10.00 mm - 32.00 mm)

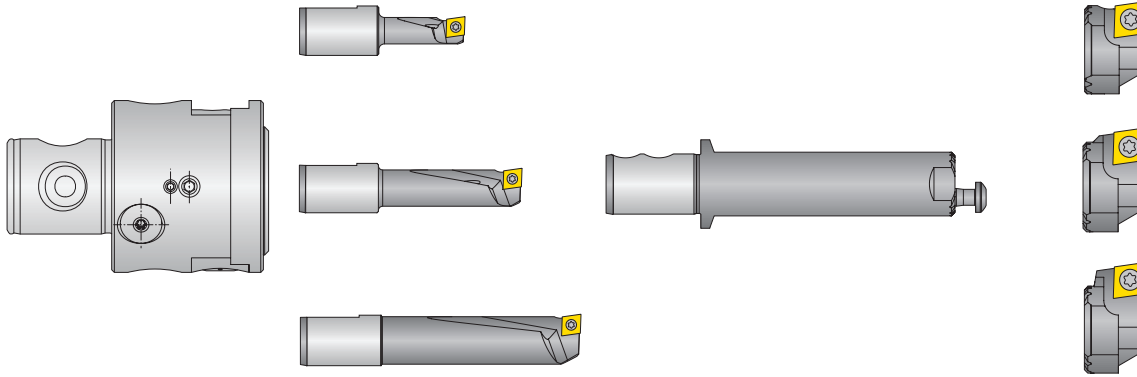

Diameter Range: 0.394" - 1.260" (10.00 mm - 32.00 mm)

	Boring Head	Boring Range	Kit Components				Kit No.	
			Boring Bars	Boring Range	Serrated Tool Body	Insert Holders		Service Keys
i	504001	0.394 - 0.433 0.551 - 0.591 0.709 - 0.748	502012 502014 502016	0.787 - 1.260	502045	502052 502054 502056	115576 (s4) 415121 (T25) 115590 (T8)	104061
m	501001	10.00 - 11.00 14.00 - 15.00 18.00 - 19.00	502012 502014 502016	20.00 - 32.00	502045	502052 502054 502056	115576 (s4) 415121 (T25) 115590 (T8)	103061

NOTE: Inserts sold separately



Key on B10-A-1

B10-M: 12-15

B10-H

B10: vi-vii

i = Imperial (in)
m = Metric (mm)
 Inserts sold separately

IMPORTANT: Max spindle speed refers to maximum possible speed for an individual boring head and is not a recommended parameter. Refer to page B10-M: 12 for recommended application-specific parameters. Factory technical assistance is available for your specific applications through our Application Engineering department.
 ext: 7611 | email: appeng@alliedmachine.com

A
B
C
D
E
F
G
H
I
J
K
L
M
INDEX

Kit Components

Insert Form 20 | Diameter Range: 0.394" - 1.260" (10.00 mm - 32.00 mm)

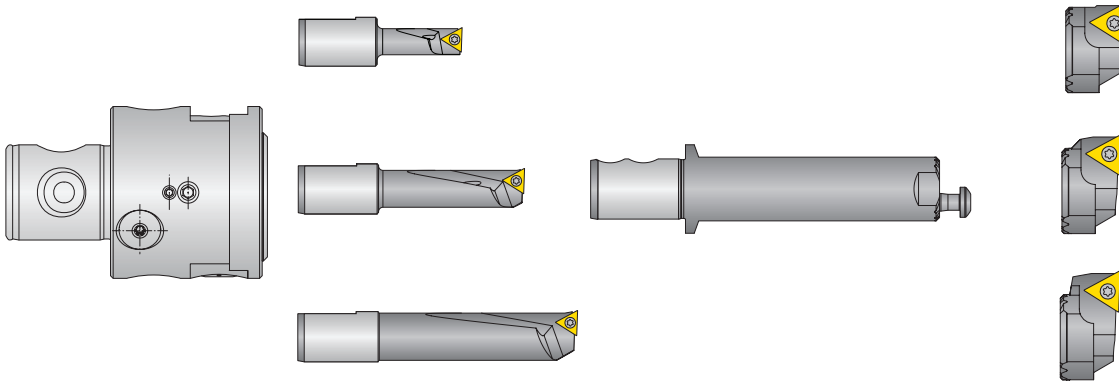

Diameter Range: 0.394" - 1.260" (10.00 mm - 32.00 mm)

		Kit Components						
	Boring Head	Boring Range	Boring Bars	Boring Range	Serrated Tool Body	Insert Holders	Service Keys	Kit No.
i	504001	0.394 - 0.433 0.551 - 0.591 0.709 - 0.748	502001 502003 502005	0.787 - 1.260	502045	502046 502048 502050	115576 (s4) 415121 (T25) 115591 (T7)	104062
m	501001	10.00 - 11.00 14.00 - 15.00 18.00 - 19.00	502001 502003 502005	20.00 - 32.00	502045	502046 502048 502050	115576 (s4) 415121 (T25) 115591 (T7)	103062

NOTE: Inserts sold separately



B10-M: 12-15 B10-H B10: vi-vii
 Key on B10-A: 1

i = Imperial (in)
m = Metric (mm)

Inserts sold separately

IMPORTANT: Max spindle speed refers to maximum possible speed for an individual boring head and is not a recommended parameter. Refer to page B10-M: 12 for recommended application-specific parameters. Factory technical assistance is available for your specific applications through our Application Engineering department.
ext: 7611 | email: appeng@alliedmachine.com

Kit Components

Insert Form 101 | Diameter Range: 1.260" - 2.677" (32.00 mm - 68.00 mm)

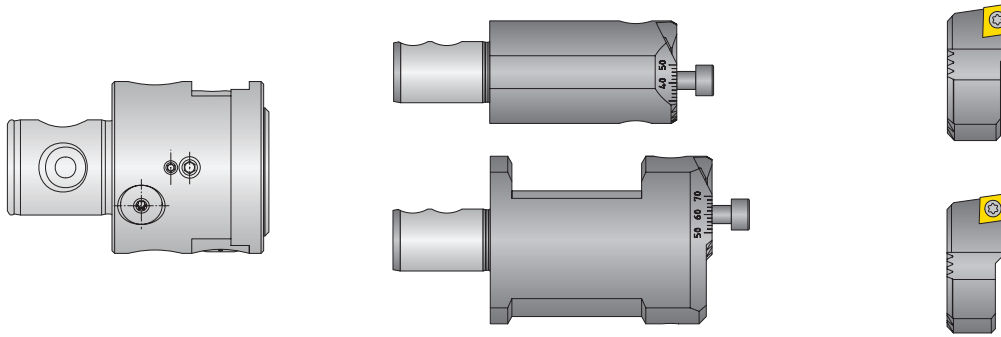

Diameter Range: 1.260" - 2.677" (32.00 mm - 68.00 mm)

	Boring Head	Kit Components				Kit No.
		Boring Range	Serrated Tool Body	Insert Holders	Service Keys	
i	504001	1.260 - 1.968	501052	502058	115576 (s4)	104063
		1.968 - 2.677	501053	502059	115590 (T8)	
m	501001	32.00 - 50.00	501052	502058	115576 (s4)	103063
		50.00 - 68.00	501053	502059	115590 (T8)	

NOTE: Inserts sold separately

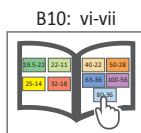
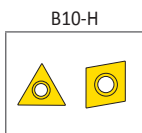
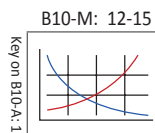

i = Imperial (in)
m = Metric (mm)
Inserts sold separately

IMPORTANT: Max spindle speed refers to maximum possible speed for an individual boring head and is not a recommended parameter. Refer to page B10-M: 12 for recommended application-specific parameters. Factory technical assistance is available for your specific applications through our Application Engineering department.
ext: 7611 | email: appeng@alliedmachine.com

A
B
C
D
E
F
G
H
I
J
K
L
M
INDEX

Kit Components

Insert Form 20 | Diameter Range: 1.260" - 2.677" (32.00 mm - 68.00 mm)

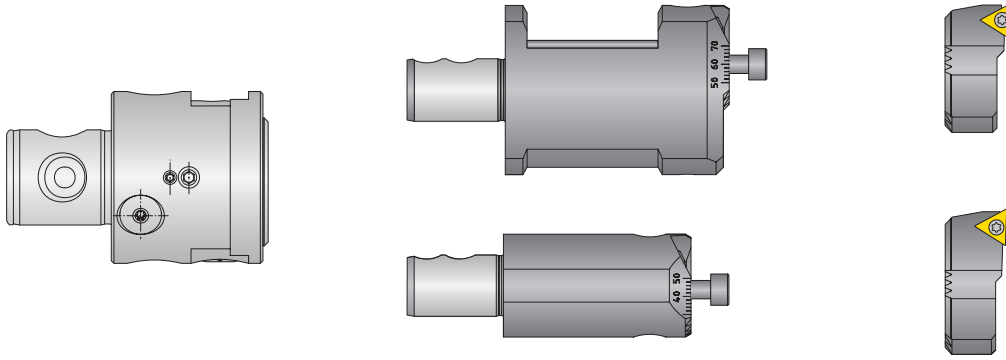

Diameter Range: 1.260" - 2.677" (32.00 mm - 68.00 mm)

		Kit Components				
	Boring Head	Boring Range	Serrated Tool Body	Insert Holders	Service Keys	Kit No.
i	504001	1.260 - 1.968	501052	502060	115576 (s4)	104064
		1.968 - 2.677	501053	502061	115591 (T7)	
m	501001	32.00 - 50.00	501052	502060	115576 (s4)	103064
		50.00 - 68.00	501053	502061	115591 (T7)	

NOTE: Inserts sold separately

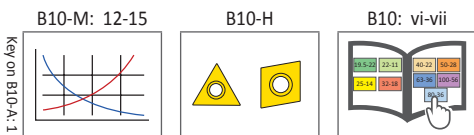

i = Imperial (in)
m = Metric (mm)

Inserts sold separately

IMPORTANT: Max spindle speed refers to maximum possible speed for an individual boring head and is not a recommended parameter. Refer to page B10-M: 12 for recommended application-specific parameters. Factory technical assistance is available for your specific applications through our Application Engineering department.
ext: 7611 | email: appeng@alliedmachine.com

Kit Components

Insert Form 101 | Diameter Range: 2.667" - 5.984" (68.00 mm - 152.00 mm)

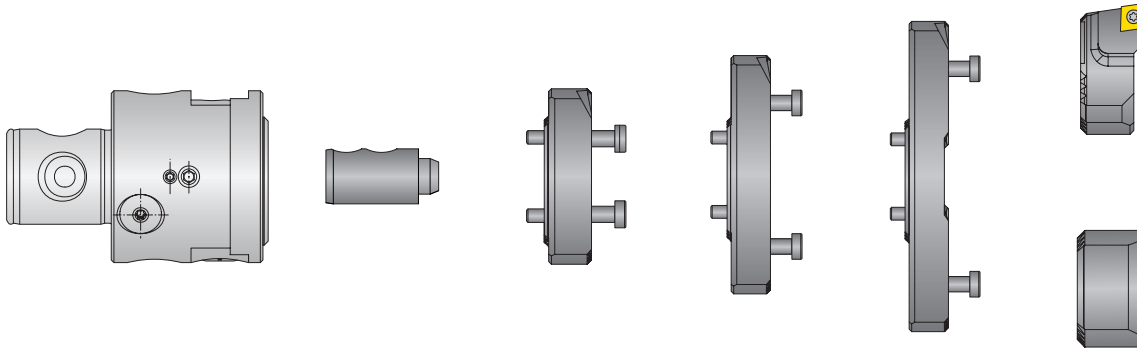

Diameter Range: 2.667" - 5.984" (68.00 mm - 152.00 mm)

		Kit Components						
	Boring Head	Boring Range	Serrated Slides	Insert Holder	Counterweight	Coolant Delivery	Service Keys	Kit No.
i	504001	2.667 - 3.780	501054	502064	502165	501157	115576 (s4)	104065
		3.780 - 4.881	501055				115590 (T8)	
		4.881 - 5.984	501056					
m	501001	68.00 - 96.00	501054	502064	502165	501157	115576 (s4)	103065
		96.00 - 124.00	501055				115590 (T8)	
		124.00 - 152.00	501056					

NOTE: Inserts sold separately

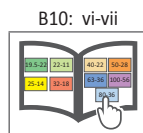
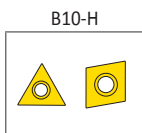
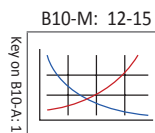

i = Imperial (in)
m = Metric (mm)
 Inserts sold separately

IMPORTANT: Max spindle speed refers to maximum possible speed for an individual boring head and is not a recommended parameter. Refer to page B10-M: 12 for recommended application-specific parameters. Factory technical assistance is available for your specific applications through our Application Engineering department.
 ext: 7611 | email: appeng@alliedmachine.com

A
B
C
D
E
F
G
H
I
J
K
L
M
INDEX

Kit Components

Insert Form 20 | Diameter Range: 2.667" - 5.984" (68.00 mm - 152.00 mm)

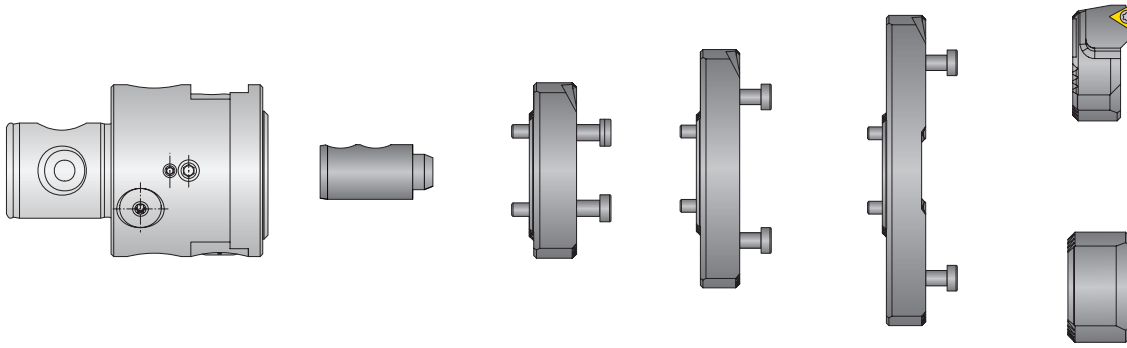

Diameter Range: 2.667" - 5.984" (68.00 mm - 152.00 mm)

		Kit Components						
	Boring Head	Boring Range	Serrated Slides	Insert Holder	Counterweight	Coolant Delivery	Service Keys	Kit No.
i	504001	2.667 - 3.780	501054	502069	502165	501157	115576 (s4)	104066
		3.780 - 4.881	501055				115591 (T7)	
		4.881 - 5.984	501056					
m	501001	68.00 - 96.00	501054	502069	502165	501157	115576 (s4)	103066
		96.00 - 124.00	501055				115591 (T7)	
		124.00 - 152.00	501056					

NOTE: Inserts sold separately

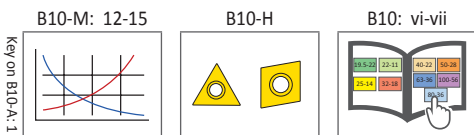

i = Imperial (in)
m = Metric (mm)

Inserts sold separately

IMPORTANT: Max spindle speed refers to maximum possible speed for an individual boring head and is not a recommended parameter. Refer to page B10-M: 12 for recommended application-specific parameters. Factory technical assistance is available for your specific applications through our Application Engineering department.
ext: 7611 | email: appeng@alliedmachine.com

Kit Components

Insert Form 101 | Diameter Range: 3.780" - 8.189" (96.00 mm - 208.00 mm)

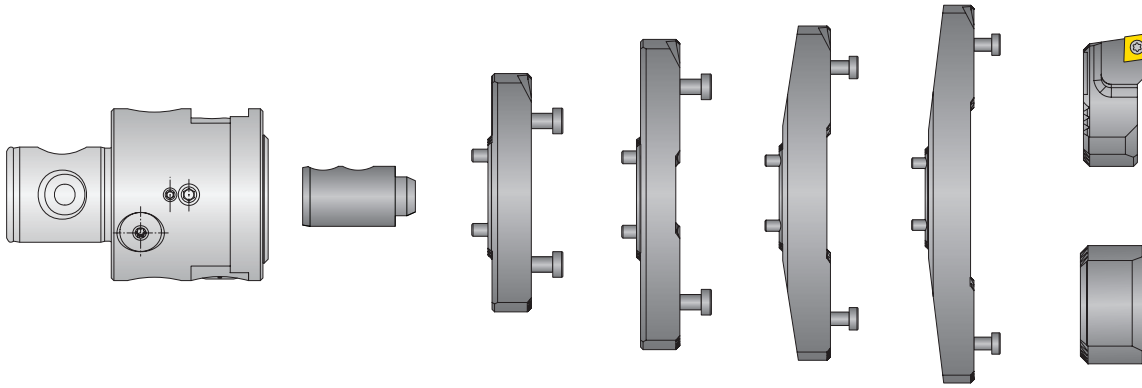

Diameter Range: 3.780" - 8.189" (96.00 mm - 208.00 mm)

		Kit Components						
	Boring Head	Boring Range	Serrated Slides	Insert Holder	Counterweight	Coolant Delivery	Service Keys	Kit No.
i	504001	3.780 - 4.881	501055	502064	502165	501157	115576 (s4) 115590 (T8)	104081
		4.881 - 5.984	501056					
		5.984 - 7.088	501058					
		7.088 - 8.189	501059					
m	501001	96.00 - 124.00	501055	502064	502165	501157	115576 (s4) 115590 (T8)	103081
		124.00 - 152.00	501056					
		152.00 - 180.00	501058					
		180.00 - 208.00	501059					

NOTE: Inserts sold separately

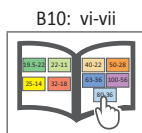
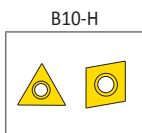
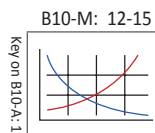

i = Imperial (in)
m = Metric (mm)
Inserts sold separately

IMPORTANT: Max spindle speed refers to maximum possible speed for an individual boring head and is not a recommended parameter. Refer to page B10-M: 12 for recommended application-specific parameters. Factory technical assistance is available for your specific applications through our Application Engineering department.
ext: 7611 | email: appeng@alliedmachine.com

A
B
C
D
E
F
G
H
I
J
K
L
M
INDEX

Kit Components

Insert Form 20 | Diameter Range: 3.780" - 8.189" (96.00 mm - 208.00 mm)

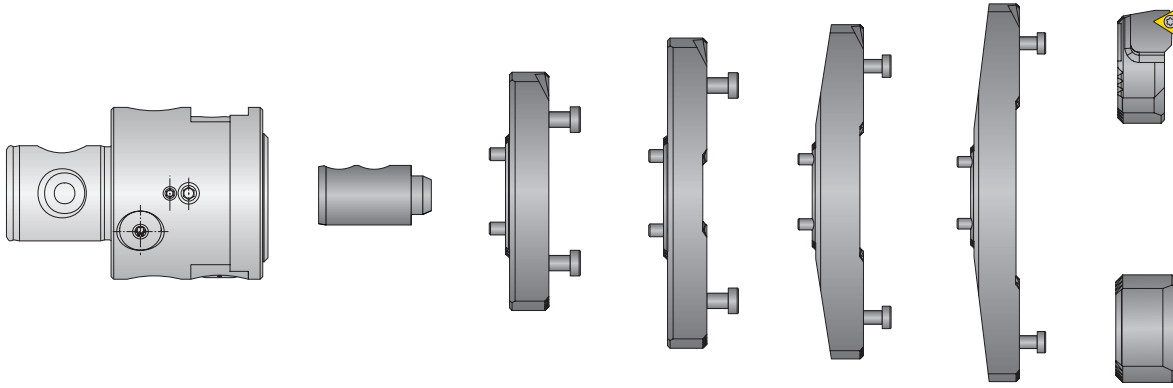

Diameter Range: 3.780" - 8.189" (96.00 mm - 208.00 mm)

		Kit Components						
	Boring Head	Boring Range	Serrated Slides	Insert Holder	Counterweight	Coolant Delivery	Service Keys	Kit No.
i	504001	3.780 - 4.881	501055	502069	502165	501157	115576 (s4) 115591 (T7)	104080
		4.881 - 5.984	501056					
		5.984 - 7.088	501058					
		7.088 - 8.189	501059					
m	501001	96.00 - 124.00	501055	502069	502165	501157	115576 (s4) 115591 (T7)	103080
		124.00 - 152.00	501056					
		152.00 - 180.00	501058					
		180.00 - 208.00	501059					

NOTE: Inserts sold separately



B10-M: 12-15 B10-H B10: vi-vii

i = Imperial (in)
m = Metric (mm)

Inserts sold separately

IMPORTANT: Max spindle speed refers to maximum possible speed for an individual boring head and is not a recommended parameter. Refer to page B10-M: 12 for recommended application-specific parameters. Factory technical assistance is available for your specific applications through our Application Engineering department.
ext: 7611 | email: appeng@alliedmachine.com